

# EMERGENCY PROCEDURE

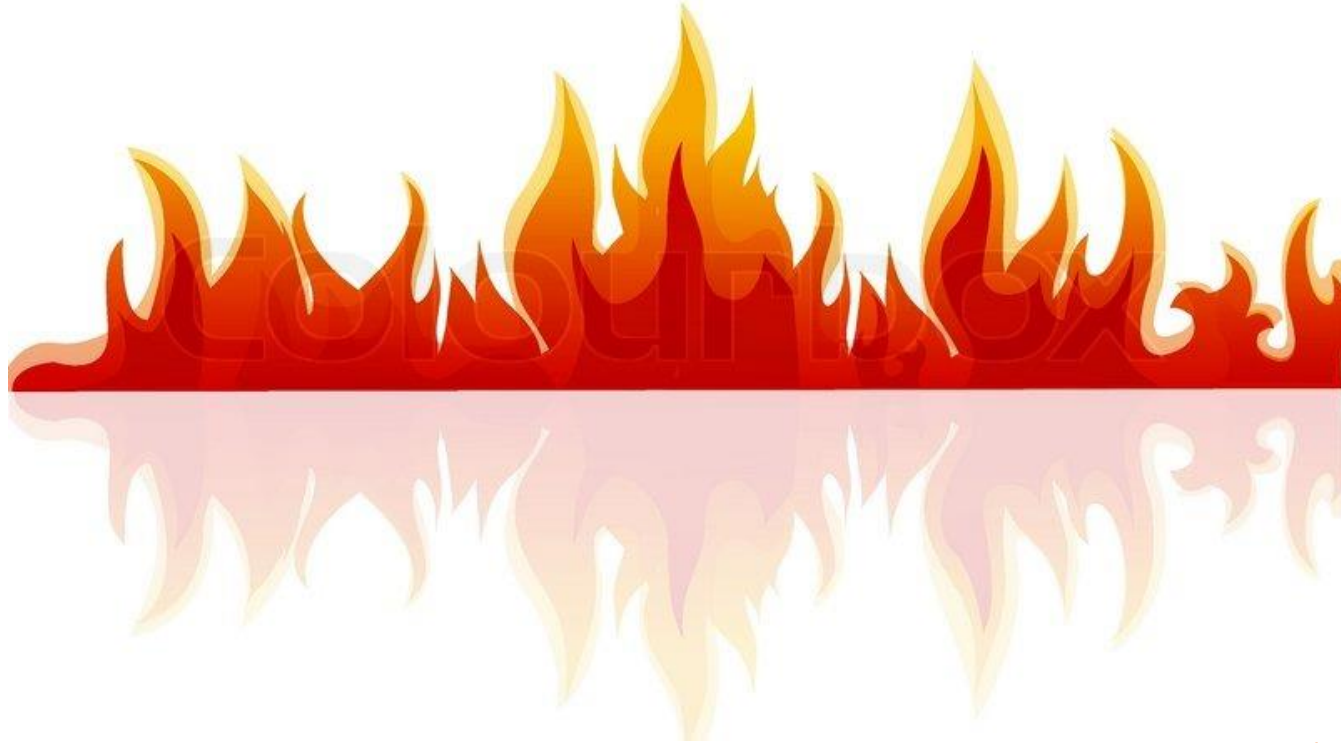

## FIRE EMERGENCY

# As a Security Officer, what is my role and responsibility? In Fire and Work Place Safety

My role is to help observe and remove of any fire hazard within the estate and to maintain workplace safety



# What action I need to do when the fire alarm is activated?

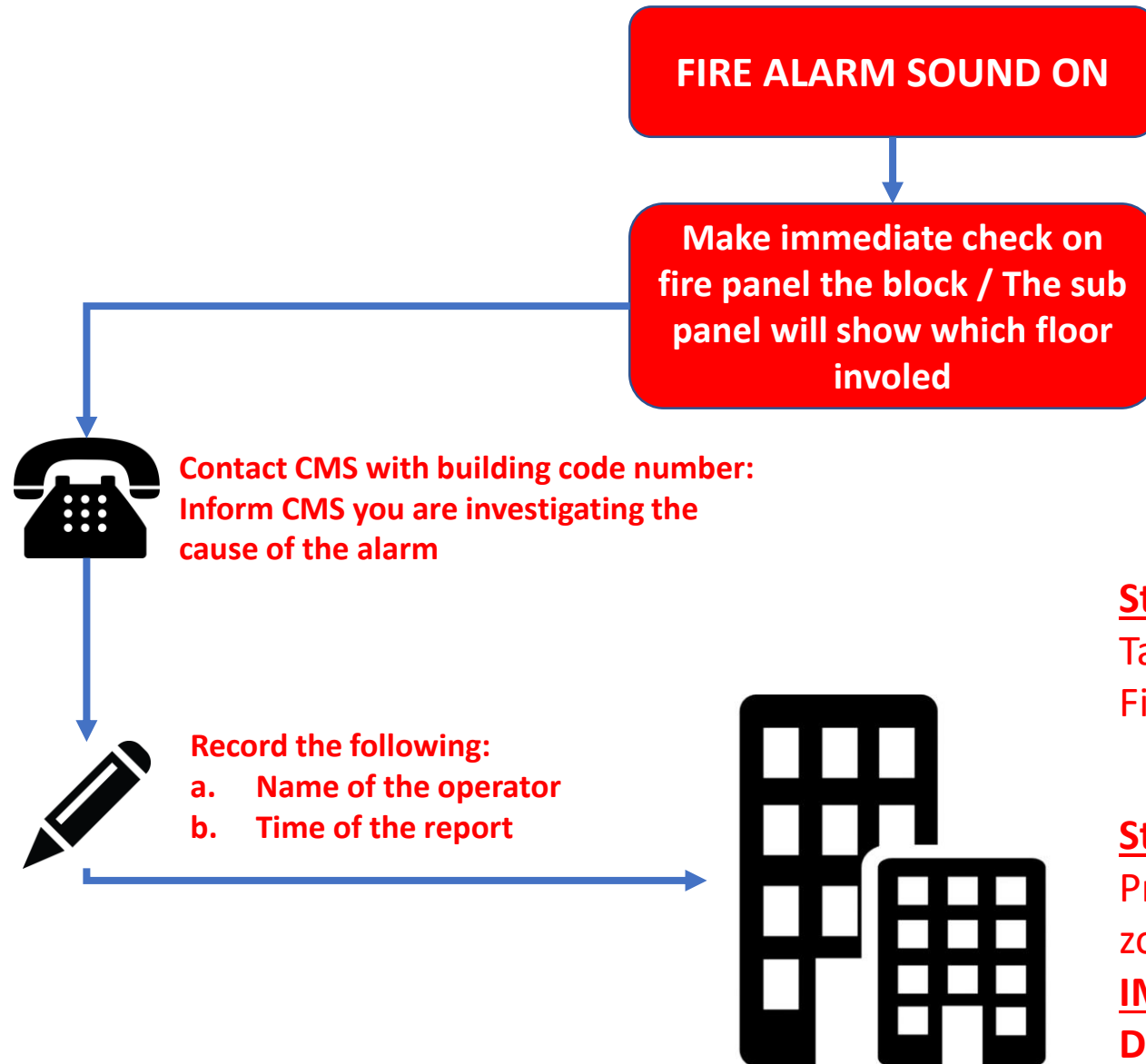

## Step 1:

Take the following equipment:  
Fire Extinguisher

## Step 2:

Proceed to effected floor to verify the zone of the alarm via **fireman's lift**  
**IMPORTANT**  
Do not go to fire floor, stop 2 floor below and walk up the stairs

# What should I do if it is a **FALSE ALARM**

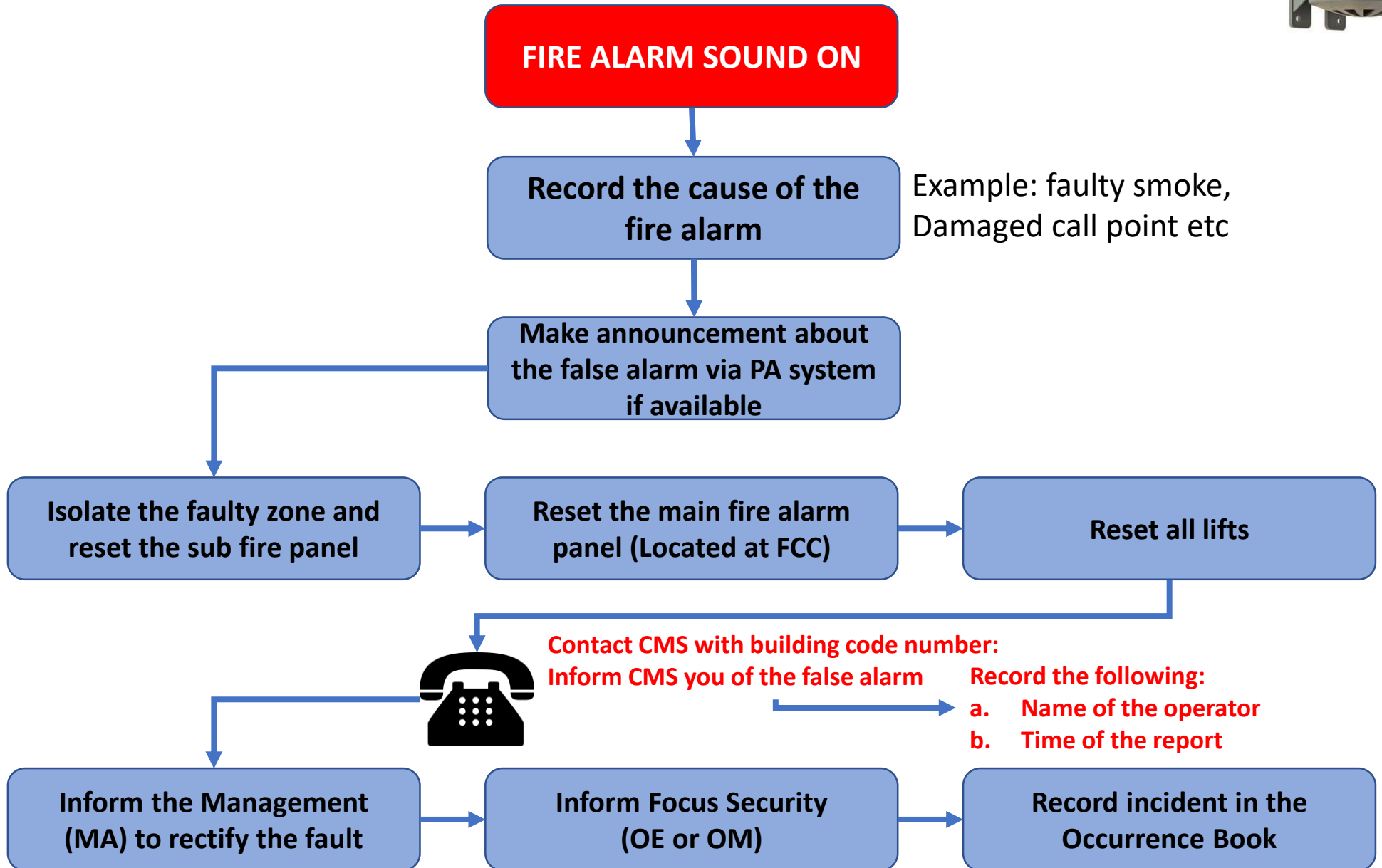

# What I should do in the event of a **REAL FIRE**

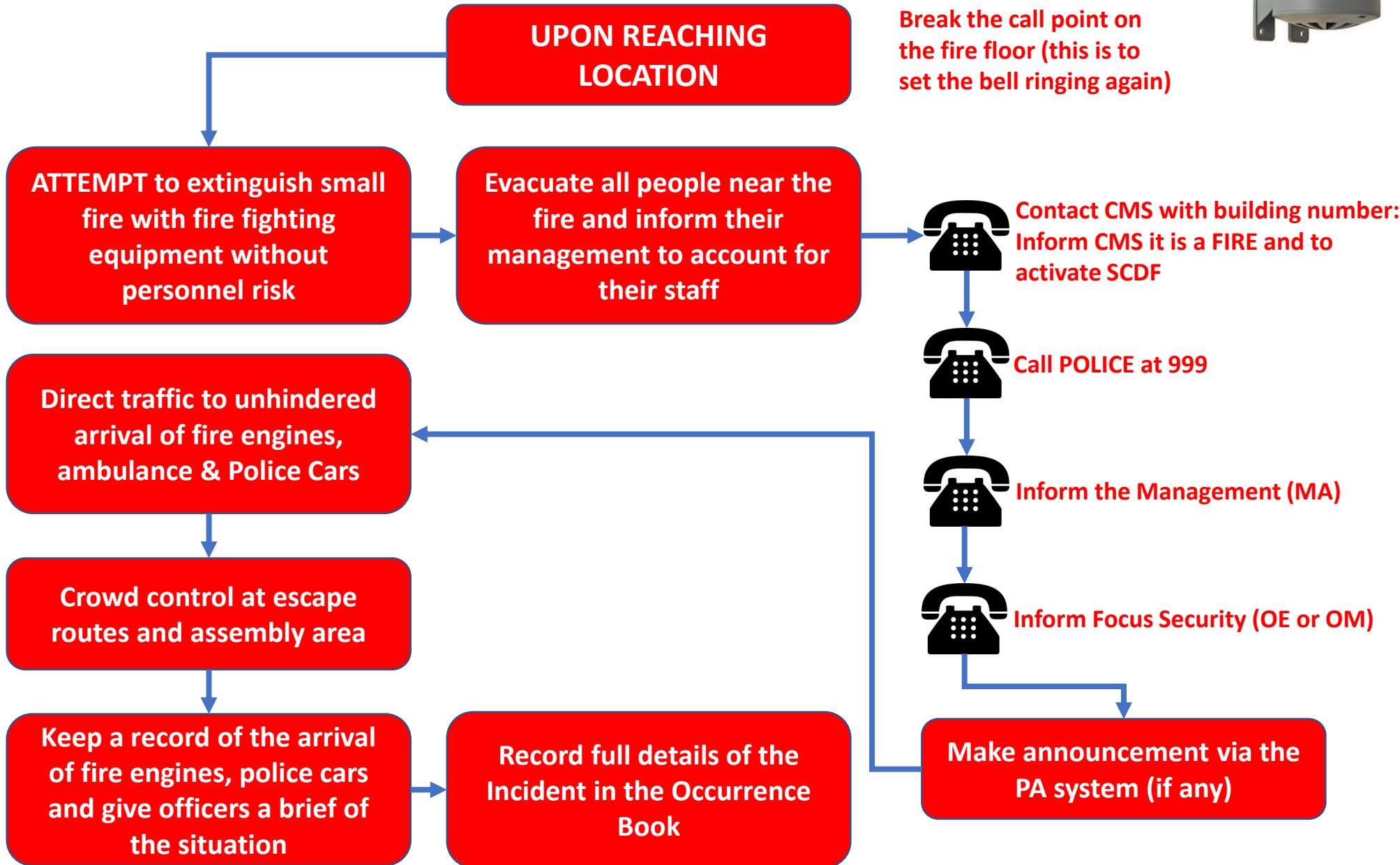

# Triangle of Fire

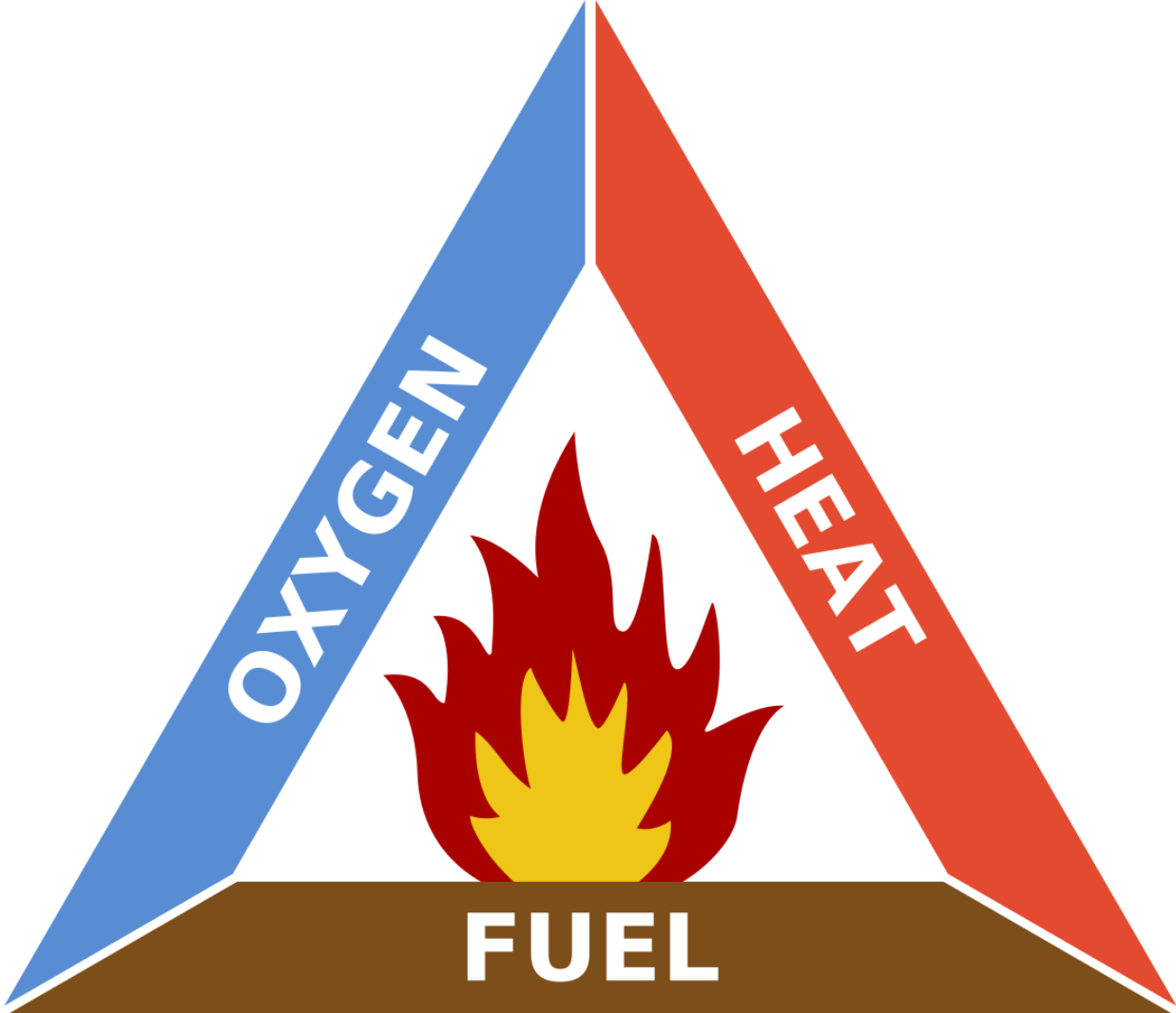

# **Taking the Fire man lift**

**Step 1: Break the Fire man glass, switch on the fire man lift**

**Step 2: Proceed to fire floor.**

# How is to use the fire extinguish?

Remember the **P A S S** Word

**P**ull

**Pull** the pin (or other motion) to unlock the extinguisher.



**A**im

**Aim** at the base (bottom) of the fire and stand 6 - 10 feet away.



**S**queeze

**Squeeze** the lever to discharge the agent.

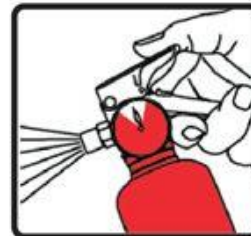

**S**weep

**Sweep** the spray from left to right until the flames are totally extinguished.





# What are the Do's and Don'ts?



- Go for the nearest staircase
- Crawl on the floor when there is smoke
- Do not take the lifts
- Do not open the door when you feel heat on the door
- Do not use water on Electrical Fire